

PSE.NET Technique Tutorial



Step by Step:

Adjust Sharpness

Use these steps to adjust sharpness.

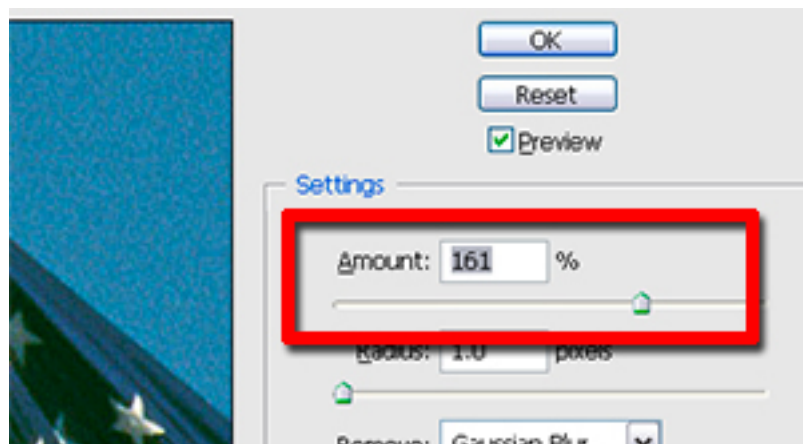

01 Select Enhance > Adjust Sharpness. Adjust the Amount slider to control the strength of the filter.

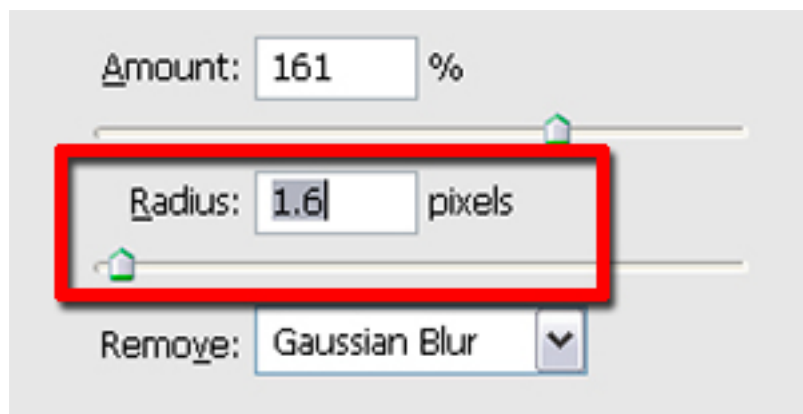

02 Adjust the Radius slider to control the number of pixels surrounding an edge that is included in the effect.

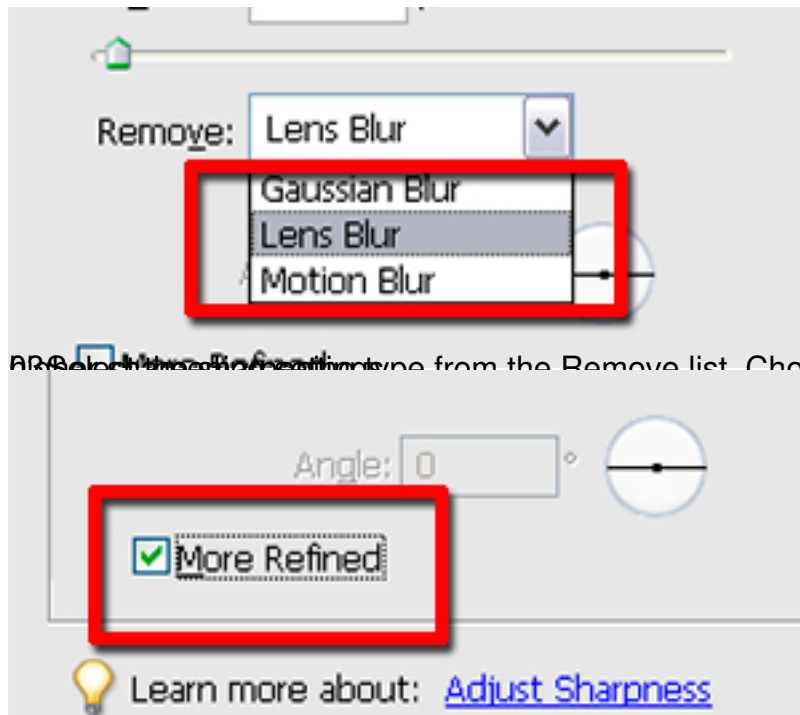

Remove the selected blur type from the Remove list. Choose Lens Blur for less halo effects at

More Refined: Check this option for more precise sharpening results but longer processing time. [Click here to see the complete list of sharpening options](#) or go to [Processing Techniques](#)